



## CHRISTOPHER WILLIAMS ARCHITECTS LLC

### *Statement of Qualifications*

#### **Representative building types**

- Administrative Offices
- Art Studios
- Athletic Facilities
- Classroom / Lecture Halls
- Dining Facilities
- Dormitories
- Faculty Residences
- Library Spaces
- Museums / Exhibit Spaces
- Research & Teaching Laboratories
- Retail Spaces
- Student Study Lounges
- Theaters / Music Practice Spaces

#### **Representative project types**

- Adaptive Re-use
- Additions
- Comprehensive Renovations
- Facility Studies
- Historic Preservation
- Infrastructure Upgrades
- Interior Design
- Master Planning
- New Construction
- Restoration

#### **FIRM OVERVIEW**

Christopher Williams Architects, LLC (CWA) is an award-winning design firm that offers full architectural services for new construction, renovation, restoration and interior architecture. As a firm that takes its cues from the master-builder tradition, we view ourselves as the project director and “responsible entity” that protects the whole while keeping all the parts moving in the right direction — we integrate a hands-on approach with 21st century technology in order to make the best buildings possible.

Founded in 1986 and based in New Haven, Connecticut, CWA's staff includes 3 registered architects with over 30 years of experience each.

#### **EXPERIENCE**

##### **Design Approach & Expertise**

CWA practices architecture in the traditional sense of the architect as generalist and leader of the project team. Our strong combined aesthetic and technical foundation allows us to make informed design decisions and marshal the efforts of specialty consultants to the best advantage of each project. Much of our work consists of transforming outmoded spaces into contextually sensitive modern environments. Typically involving complicated programmatic / spatial requirements on restrictive budgets, we have time and again overcome challenging existing conditions to create such spaces.

##### **Long Term Institutional Clients**

Since 1990, CWA has maintained an on-going relationship with Yale University and we have been working with them since 2009 in an on-call capacity. In that time we have completed approximately 350 projects ranging in construction dollar value from \$50,000 to \$23,500,000. We currently hold “on-call” agreements with several municipalities in Connecticut and have been completing ongoing work for the cities of New Haven (since 1990), New London and Stamford. Additionally on our roster of “on-call” clients are the State of Connecticut Department of Construction Services, the University of Connecticut, Southern Connecticut State University, Williams College and Connecticut State Colleges & Universities.





## CHRISTOPHER WILLIAMS ARCHITECTS LLC

### Statement of Qualifications

#### OUR TEN RULES

1. Listen
2. Prepare
3. Explore
4. Courage
5. Communicate
6. Teamwork
7. Translate
8. Empathize
9. Nurture
10. Roll With The Punches

#### EXCEPTIONAL OUTCOMES

Big or small, high visibility or low profile, straightforward or complex, we bring the same scrupulous attention to each and every project. Guided by **OUR TEN RULES** (described in depth at [ourtenrules.com](http://ourtenrules.com)), we have earned our client's trust and respect through responsive service and thoughtful problem solving that balances technical expertise, design sensibility and budgetary discipline.

"Renovating Greeley Lab not only saved the building for the University, but has set a standard for the preservation of mid-century buildings all over the world."

Robert AM Stern - Former Dean, Yale School of Architecture

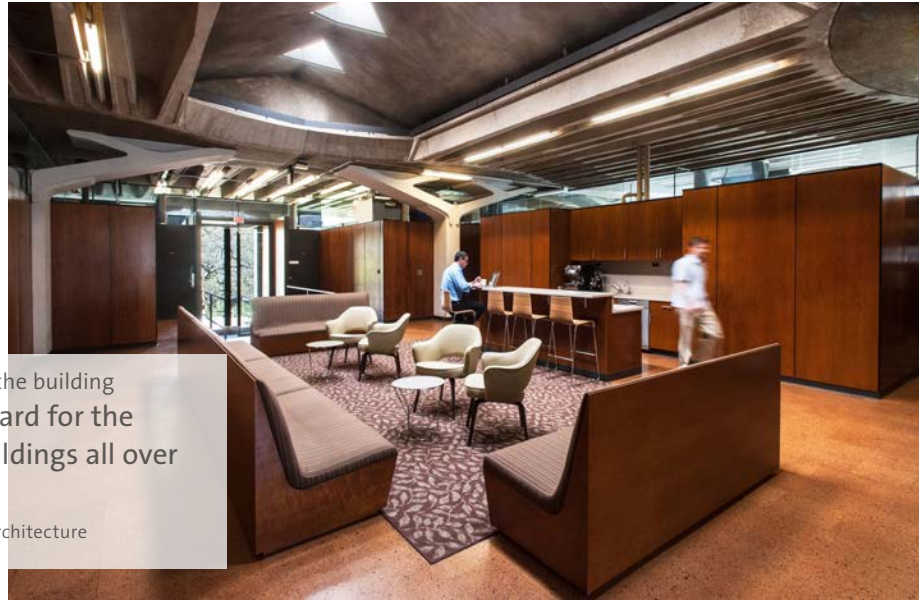

"CWA listened to our needs and created a light and spacious area in which the students could study. This design exceeded all expectations and the final result fully fits the bill."

Joann DelVecchio - Operations Manager

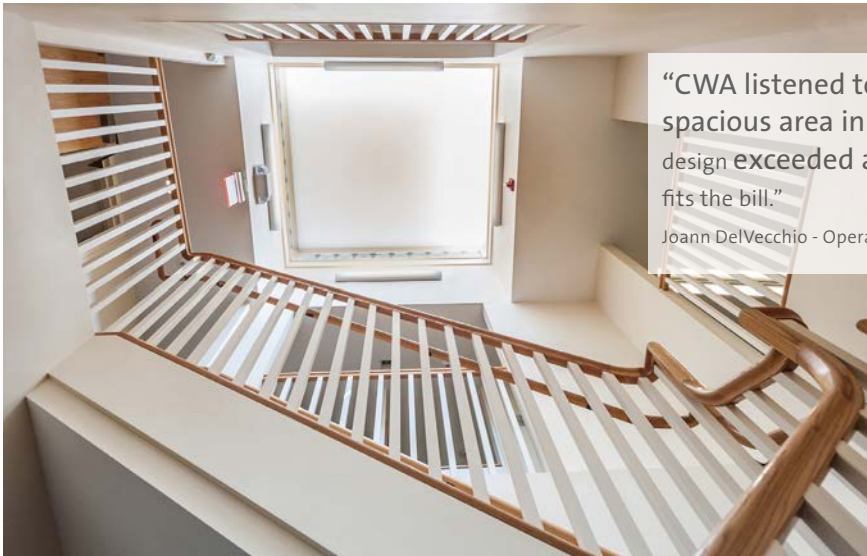

"Working with CWA was an incredibly positive experience. They absorbed a huge number of potentially conflicting requirements and found a way to accommodate them all in the very challenging site."

Jack Harris - Principal Investigator

